

Dear Mr. Moles

The Chilmark Selectmen voted and approved the expansion of Menemsha Pond private aquaculture area. There are currently six oyster farms and the approved expansion area would result in four additional farms. The Town of Chilmark would like to request permission from DMF to expand this area. Upon approval from DMF the Selectmen would like to request a dive survey to rule out any conflicts with native eelgrass and shellfish beds.

The Chilmark Board of Selectmen also approved another aquaculture area designated as offsite culling. This area would be available to all Chilmark oyster growers. This area is located along the Menemsha Channel in Menemsha Pond and shares the same growing area designation (V2). If approved by DMF, this area will be used for oyster seed growout through the use of a tidal upweller. This area will be used for seed growout and for landing product before selling. In order to keep future requests for designated upweller sites and potential conflicts with other pond usage to a minimum Chilmark designated this area. Having a central place for farmers to land shellfish and cull seed will aid Chilmark in enforcing compliance with the Vibrio Control Plan. With only three of the six farms currently selling adult oysters and the potential for additional four more upon approval Chilmark would like to be proactive for necessary infrastructure. Detailed plans for this equipment and location coordinates are provided with this letter.

Information provided with this request letter:

Expansion of Aquaculture Area

1. Map detailing the aquaculture expansion area of Menemsha Pond (Growing Area V2).
2. Tables that provide coordinates of the existing and proposed oyster grants/leases.
3. A letter from the Chilmark Board of Selectmen approving the expansion of this area.

Off Site Culling Area and Upweller Nursery Location

1. Map detailing the proposed offsite culling / upweller nursery area.
2. Tables that provide coordinates for the offsite culling area.

**Individual Site Coordinates-**

**Town of Chilmark**

**Menemsha Pond (V2) Proposed Aquaculture Site Coordinates**

#		Northeast Boundary		Northwest Boundary		Southeast Boundary		Southwest Boundary
7	Latitude	41°20'12.22"N	Latitude	41°20'12.25"N	Latitude	41°20'11.44 "N	Latitude	41°20'11.45 "N
	Longitude	70°46' 14.09"W	Longitude	70°46' 21.96"W	Longitude	70°46'14.93 "W	Longitude	70°46'22.84 "W
8	Latitude	41°20'10.63 "N	Latitude	41°20'10.66 "N	Latitude	41°20'9.82 "N	Latitude	41°20'9.89 "N
	Longitude	70°46'15.82 "W	Longitude	70°46'23.74 "W	Longitude	70°46'16.66 "W	Longitude	70°46'24.56 "W
9	Latitude	41°20'8.94 "N	Latitude	41°20'8.97 "N	Latitude	41°20'8.15 "N	Latitude	41°20'8.18 "N
	Longitude	70°46'17.64 "W	Longitude	70°46'25.61 "W	Longitude	70°46'18.47 "W	Longitude	70°46'26.50 "W
10	Latitude	41°20'7.18 "N	Latitude	41°20'7.20 "N	Latitude	41°20'6.38 "N	Latitude	41°20'6.43 "N
	Longitude	70°46'19.52 "W	Longitude	70°46'27.59 "W	Longitude	70°46'20.37 "W	Longitude	70°46'28.45 "W

**Overall New Area Designated for Aquaculture**

**Town of Chilmark**

**Menemsha Pond (V2)**

	Northeast Boundary		Northwest Boundary		Southeast Boundary		Southwest Boundary
Latitude	41°20'12.22"N	Latitude	41°20'12.25"N	Latitude	41°20'6.38 "N	Latitude	41°20'6.43 "N
Longitude	70°46' 14.09"W	Longitude	70°46' 21.96"W	Longitude	70°46'20.37 "W	Longitude	70°46'28.45 "W

**Individual Site Coordinates-Converted for GPS**

**Town of Chilmark**

**Menemsha Pond (V2) Proposed Aquaculture Site Coordinates**

#	Northeast Boundary			Northwest Boundary			Southeast Boundary			Southwest Boundary		
7	Latitude	N 41°	20.204'	Latitude	N 41°	20.204'	Latitude	N 41°	20.191'	Latitude	N 41°	20.191'
	Longitude	W 70°	46.235'	Longitude	W 70°	46.366'	Longitude	W 70°	46.249'	Longitude	W 70°	46.381'
8	Latitude	N 41°	20.177'	Latitude	N 41°	20.178'	Latitude	N 41°	20.164'	Latitude	N 41°	20.165'
	Longitude	W 70°	46.264'	Longitude	W 70°	46.396'	Longitude	W 70°	46.278'	Longitude	W 70°	46.409'
9	Latitude	N 41°	20.149'	Latitude	N 41°	20.150'	Latitude	N 41°	20.136'	Latitude	N 41°	20.136'
	Longitude	W 70°	46.294'	Longitude	W 70°	46.427'	Longitude	W 70°	46.308'	Longitude	W 70°	46.442'
10	Latitude	N 41°	20.120'	Latitude	N 41°	20.120'	Latitude	N 41°	20.106'	Latitude	N 41°	20.107'
	Longitude	W 70°	46.325'	Longitude	W 70°	46.460'	Longitude	W 70°	46.340'	Longitude	W 70°	46.474'

**Overall New Area Designated for Aquaculture-Converted for GPS**

**Town of Chilmark**

**Menemsha Pond (V2)**

	Northeast Boundary			Northwest Boundary			Southeast Boundary			Southwest Boundary		
Latitude	N 41°	20.204'	Latitude	N 41°	20.204'	Latitude	N 41°	20.106'	Latitude	N 41°	20.107'	
Longitude	W 70°	46.235'	Longitude	W 70°	46.366'	Longitude	W 70°	46.34'	Longitude	W 70°	46.474'	

# Town of Chilmark Proposed Oyster Grant/Lease Locations

Menemsha Pond (Chilmark)

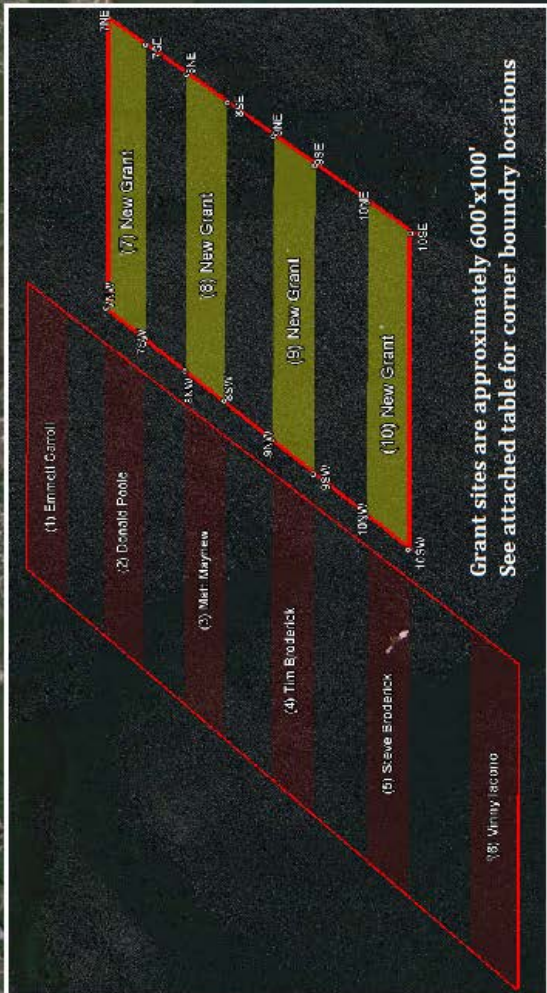

Locations of 4 New Oyster Grants

6 Existing Oyster Grants



© 2015 Google

Google earth

1690 ft

1995

Imagery Date: 6/16/2014 41°20'14.63" N 70°46'37.57" W elev 0 ft eye alt 7486 ft

Town of Chilmark  
 Proposed Off-site Culling & Upweller Area  
 Menemsha Channel (V2)



Oyster growers will only be able to use this area if they list it as off-site culling on their propagation permit from DMF.

**Proposed Off-Site Culling & Upweller Area Coordinates**

**Town of Chilmark**  
**Menemsha Channel (V2)**

#	Description	Northeast Boundary	Northwest Boundary	Southeast Boundary	Southwest Boundary
	Off-Site Culling &	Latitude 41°21'9.26"N	Latitude 41°21'9.00"N	Latitude 41°21'7.82"N	Latitude 41°21'7.59"N
	Upweller	Longitude 70°45'59.91"W	Longitude 70°46'0.35"W	Longitude 70°45'58.77"W	Longitude 70°45'59.21"W

**Proposed Off-Site Culling & Upweller Area Coordinates**

**Converted to GPS Format**  
**Menemsha Channel (V2)**

#	Description	Northeast Boundary	Northwest Boundary	Southeast Boundary	Southwest Boundary
	Off-Site Culling &	Latitude 41°21 .154'N	Latitude 41°21 .150'N	Latitude 41°21 .130'N	Latitude 41°21 .127'N
	Upweller	Longitude 70°45 .999'W	Longitude 70°46 .006'W	Longitude 70°45 .980'W	Longitude 70°45 .987'W